

WD 6 P S V-30/6/22/T

The WD 6 P S V-30/6/22/T combines ultra-powerful suction and energy efficiency. With a 30 l stainless steel container, a flat pleated filter that is cleaned at the push of a button, a blower function and an integrated power outlet.



Order no. **1.628-360.0**

- Flat pleated filter with patented filter removal technology
- Filter cleaning
- Power outlet with automatic on/off switch for working with power tools

Technical data

EAN code		4054278661810
Energy use	W	1300
Rated input power integrated socket	W	min. 100 - max. 2100
Container capacity	l	30
Container material		Stainless steel
Power cable	m	6
Standard accessory ID	mm	35
Supply voltage	V / Hz	220 - 240 / 50 - 60
Colour		Yellow
Weight without accessories	kg	9.3
Weight incl. packaging	kg	12.9
Dimensions (L × W × H)	mm	418 × 382 × 693

Equipment

Suction hose	m	2.2 / with curved handle / Plastic
Removable handle with electrostatic protection		■
Suction tubes	Piece(s) × m / mm	2 × 0.5 / 35 / Stainless steel
Wet and dry floor nozzle		Switchable
Crevice nozzle		■
Flexible suction hose	m / mm	1 / 35
Adaptor for connecting power tools		■
Fleece filter bag	Piece(s)	1
Flat pleated filter		in removable filter box
Power outlet with automatic on/off switch		■
Filter cleaning function		■
Rotary switch (on/off)		■
Power control		■
Blower function		■
Intermediate parking position of the handle on the device head		■
Hose storage on the device head		■
Storage space for small parts		■
Convenient 3-in-1 carrying handle		■
Cable hook		■
Parking position		■
Accessory storage on the device		■

Drain screw	■
Sturdy bumper	■
Swivel castors	Piece(s) 5

■ included in the scope of supply.



Power outlet with automatic on/off switch for working with power tools

- Dirt that is a result of planing, sawing or grinding is suctioned away directly.
- The vacuum cleaner is switched on and off automatically via the power tool.



Outstanding filter cleaning

- Strong pulse air streams move the dirt from the filter into the container at the push of a button.
- The full suction power is quickly restored.



Patented filter removal technology

- Quick and easy removal of the filter from the filter box – without contact with dirt.
- For wet and dry vacuuming without filter replacement.

ACCESSORIES FOR WD 6 P S V-30/6/22/T

1.628-360.0

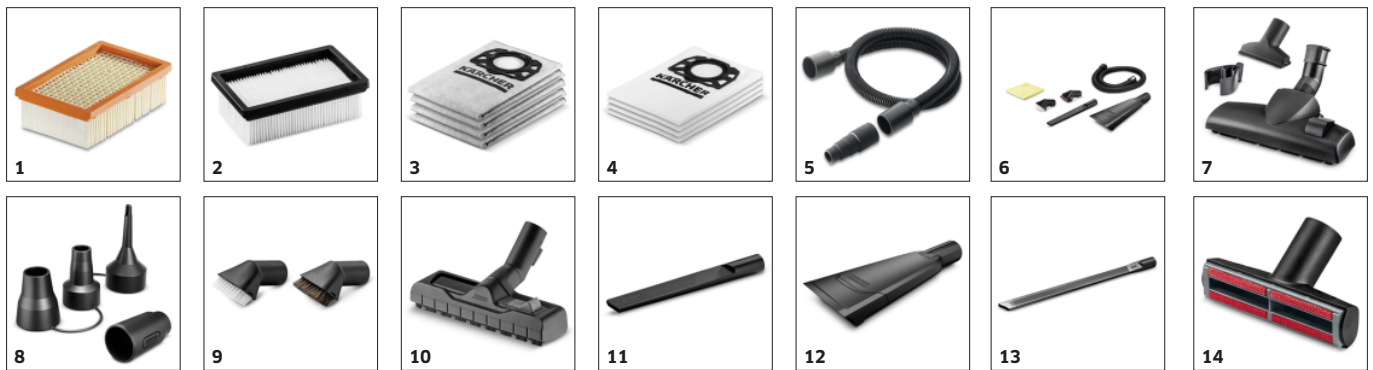

	Order no.	Description	
VACUUMS			
Filters			
Flat pleated filter KFI 4410	1 2.863-005.0	Flat pleated filter for vacuuming fine and coarse dirt and liquids without having to change the filter. Suitable for Kärcher Home & Garden wet and dry vacuum cleaners.	■
Flat-pleated filter Renovation KFI 4440	2 2.863-354.0	Special flat pleated filter for long-lasting suction power when vacuuming fine dust during renovations and when working with power tools. Suitable for Kärcher wet and dry vacuum cleaners.	□
Fleece filter bags Renovation KFI 489	3 2.863-355.0	Special fleece filter bag for long-lasting suction power when vacuuming fine dust during renovations and when working with power tools. Suitable for Kärcher wet and dry vacuum cleaners.	□
Fleece filter bags KFI 487	4 2.863-006.0	Extremely tear-resistant fleece filter bag, ideal for vacuuming dry and damp dirt. Suitable for Kärcher Home & Garden wet and dry vacuum cleaners and spray extraction cleaners.	□
Accessory kits			
Vacuum kit for power tools	5 2.863-112.0	Flexible suction hose (1 m) including adapter for connection to the exhaust air vent of power tools (e.g. jigsaws, grinders, drills, planes, etc.), for dirt-free DIY.	■
Car interior cleaning kit	6 2.863-304.0	From the footwell and the seats to the car boot: the special accessory kit for Kärcher Home & Garden wet and dry vacuum cleaners ensures uninterrupted interior car cleaning.	□
Household kit	7 2.863-356.0	Handy accessory kit for switching between dry floor nozzle and upholstery nozzle. Suitable for all Kärcher Home & Garden wet and dry vacuum cleaners and spray extraction cleaners.	□
Blower adapter kit	8 2.863-373.0	Ensures effortless inflation and deflation of air mattresses, swimming pools, inflatable boats, etc. using a Kärcher Home & Garden wet and dry vacuum cleaner.	□
Suction brush kit	9 2.863-221.0	The suction brush kit enables thorough interior car cleaning of dashboards, foot mats, upholstered surfaces, etc., and is suitable for use on all materials. For all Home & Garden wet and dry vacuum cleaners.	□
Nozzles			
Switchable wet and dry floor nozzle with integrated parking nib	10 2.863-000.0	Switchable wet and dry vacuum nozzle for perfect dirt intake. Easy adaptation to wet or dry dirt using foot switch. For all Kärcher Home & Garden wet and dry vacuum cleaners.	■
Extra-long crevice nozzle	11 2.863-306.0	Completely overhauled extra-long crevice nozzle. Ideal for hard-to-reach places in the car (e.g. gaps and crevices/joints). Suitable for all Kärcher Home & Garden wet and dry vacuum cleaners.	□
Car nozzle	12 2.863-316.0	Fast, effortless vacuuming guaranteed: With the car nozzle, you can clean textile surfaces in your car and around the house conveniently and thoroughly.	□
Flexible crevice nozzle	13 2.863-374.0	Flexible crevice nozzle for cleaning hard-to-reach areas in the home, basement, workshop, car, etc. with Home & Garden wet and dry vacuum cleaners and spray extraction cleaners.	□
Upholstery nozzle for pet hair	14 2.863-375.0	Extra wide upholstery nozzle for reliably removing dirt, especially animal hair, from car and home textiles with Home & Garden wet and dry vacuum cleaners and spray extraction cleaners.	□

■ Included in the scope of supply. □ Available accessories. ○ Detergents.

ACCESSORIES FOR WD 6 P S V-30/6/22/T 1.628-360.0

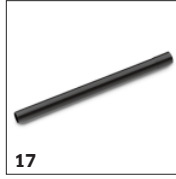

		Order no.	Description	
VACUUMS				
Special applications				
Drill dust catcher	15	2.863-234.0	The new accessory for our WD 2-6 wet and dry vacuum cleaners enables safe and dust-free drilling on all common wall and ceiling surfaces. Drill dust is suctioned directly from the drill hole.	<input type="checkbox"/>
Suction hose extension	16	2.863-305.0	The 3.5-m long suction hose extension is suitable for all Kärcher wet and dry vacuum cleaners from the Home & Garden range and ensures a larger operating radius and greater freedom of movement.	<input type="checkbox"/>
Extension suction tube	17	2.863-308.0	Practical extension suction tube for greater operating range. The extension of the suction tube is recommended particularly for applications in areas that are difficult to access, such as high ceilings.	<input type="checkbox"/>

■ Included in the scope of supply. Available accessories. Detergents.