



### Warning

*These are only brief instructions! Please read and comply with these instructions prior to using or servicing your appliance.*

The non-compliance of the operating and safety instructions may lead to damages of the appliance and to dangers for the operator and other persons.

## Start up

# 1

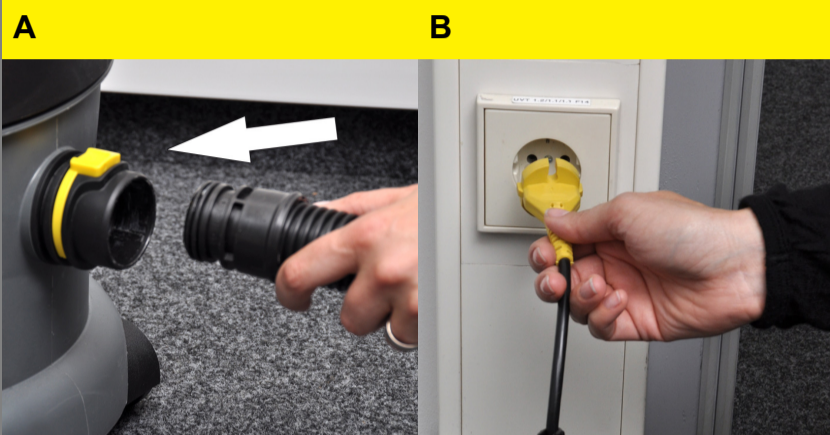

- A Insert the suction hose into the suction hose connection on the appliance.
- B Plug in the mains plug.

## Operation

# 1

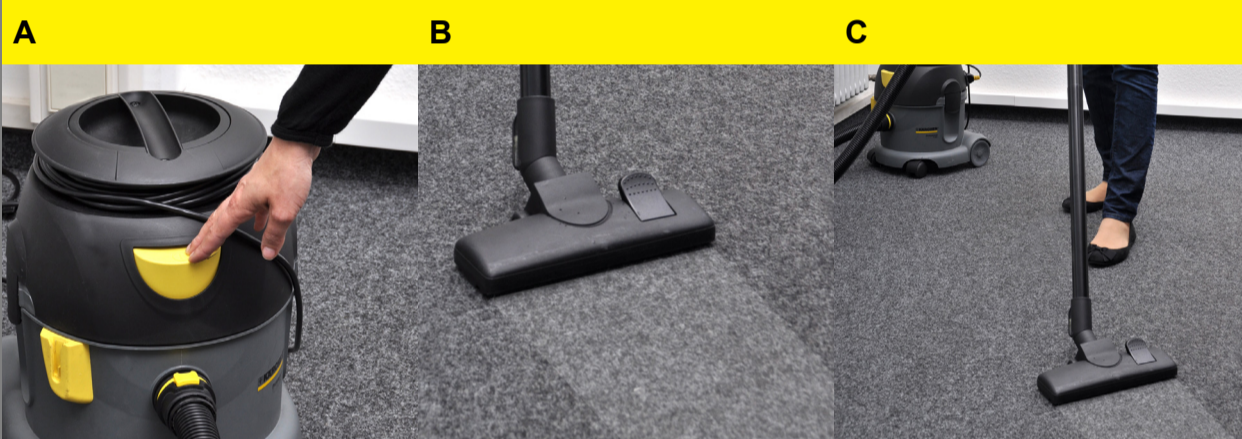

- A Switch on the appliance at the main switch.
- B Regulate the suction force on the suction force regulator (continuous). Set the selection switch of the floor nozzle to hard surface or carpet.
- C Perform the cleaning operation.

## Finish operation

# 1

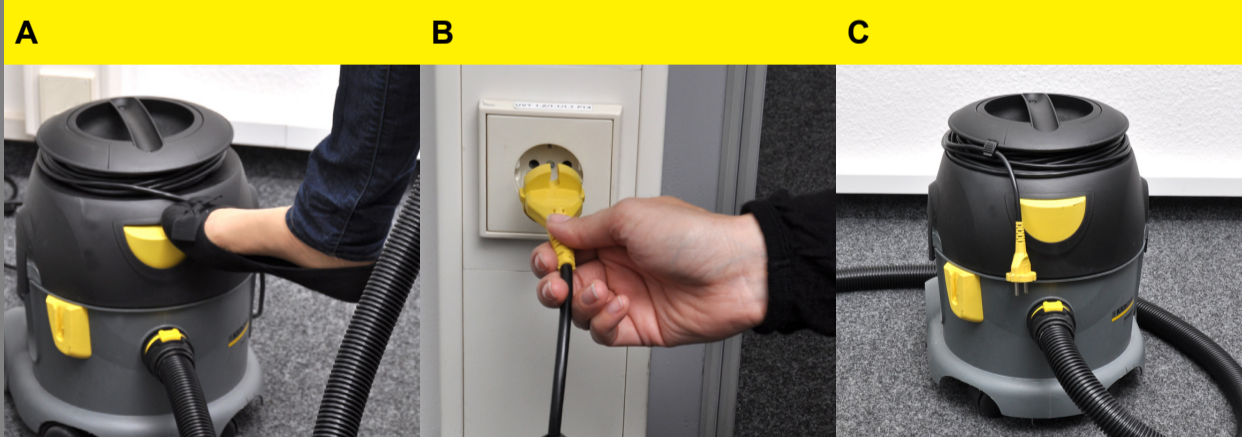

- A Switch off the appliance at the main switch.
- B Pull out the mains plug.
- C Cable coiling  
Parking position T 10/1.

## Maintenance and care

daily

weekly

Kärcher Customer Service

1

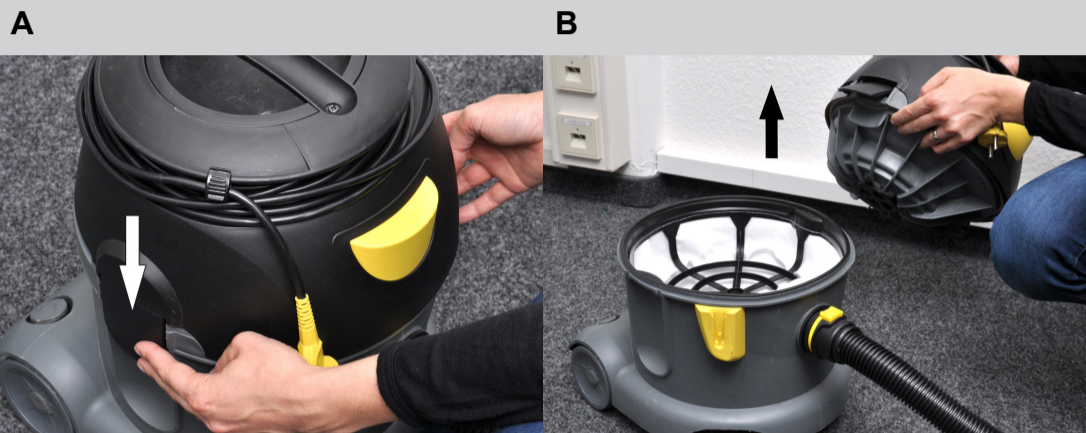

A Release and remove the suction head.

2



A Remove the main filter basket.  
B Replace the fleece filter bag or paper filter bag (option).

3



A Insert main filter basket.  
B Insert and lock the suction head.

4

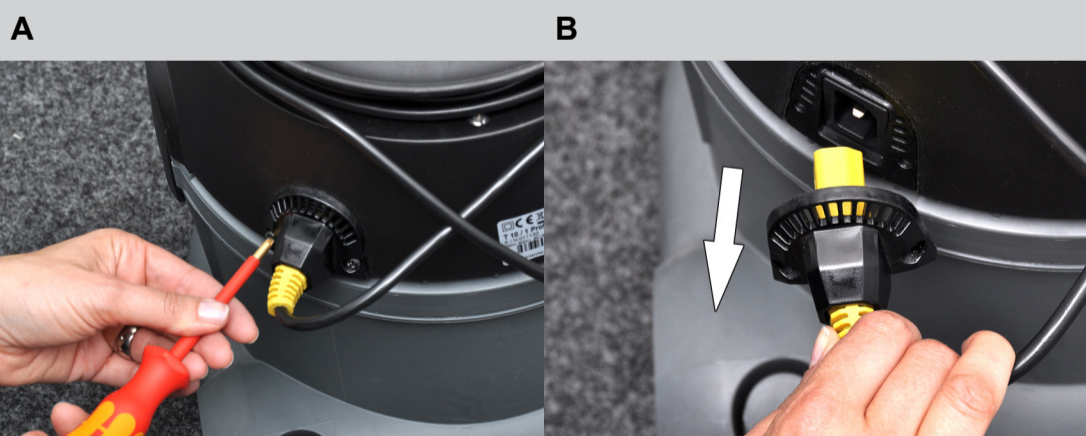

**⚠ Danger**  
*Risk of electric shock! Pull the mains plug before carrying out tasks on the appliance.*  
A Replace the mains cable. Unscrew the screws of the strain relieve by means of a screwdriver.  
B Unplug the faulty mains cable.

5

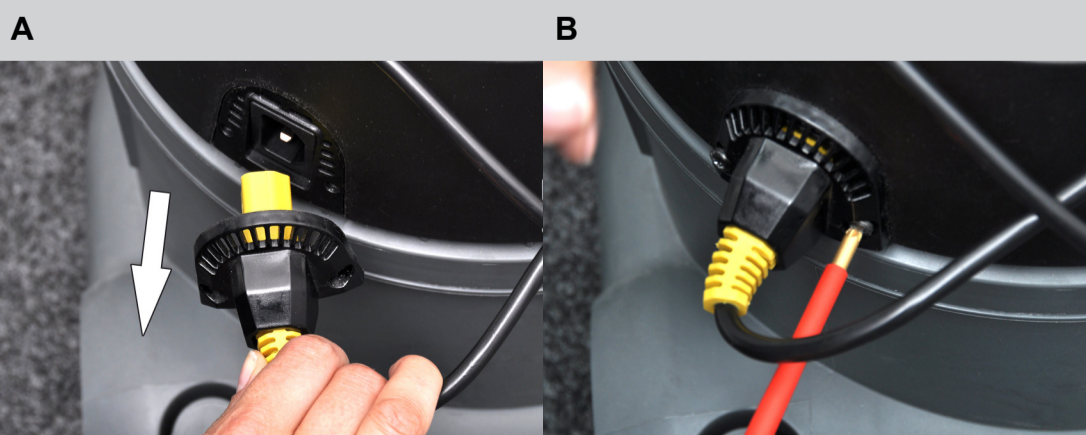

A Connect a new mains cable.  
B Tighten the screws of the strain relieve by means of a screwdriver.